

STATE OF OKLAHOMA
DEPARTMENT OF TRANSPORTATION

PLAN OF PROPOSED
CITY STREET

FEDERAL AID PROJECT NO. ACNHPPI-XTWN (079)SS
GRADE, DRAIN, & SURFACE PLANS
OKLAHOMA CITY BOULEVARD
OKLAHOMA COUNTY

CONTROL SECTION NO. 40-55-69
JOB PIECE NO. 17428(89)
WORK PACKAGE 5.1c

FOR SURVEY CONTROL DATA,
SEE SURVEY DATA SHEETS.

REV. NO.	DESCRIPTION	DATE
△	UPDATED INDEX OF SHEETS	12-15-2015
△	UPDATED INDEX OF SHEETS	3-15-2016
△	UPDATED TRAFFIC STANDARDS	11-11-2016
△	UPDATED INDEX OF SHEETS AND TRAFFIC STANDARDS	5-12-2017

INDEX OF SHEETS

SHEET NO.	DESCRIPTION
1	TITLE SHEET
2-5	TYPICAL SECTIONS (1)-(4)
6	SUMMARY OF PAY QUANTITIES (ROADWAY)
7	SUMMARY OF PAY QUANTITIES (TRAFFIC CONTROL)
8	SUMMARY OF PAY QUANTITIES & NOTES (TRAFFIC SIGNAL)
9	SUMMARY OF PAY QUANTITIES & NOTES (SIGNING & STRIPING)
10	SUMMARY OF PAY QUANTITIES & NOTES (LIGHTING)
10A	SUMMARY OF PAY QUANTITIES & NOTES (I-40 CROSSTOWN LIGHTING)
11-12	SUMMARY SHEET (1)-(2)
13-15	DEMOLITION SHEET (1)-(3)
16	STORM WATER MANAGEMENT PLAN
17-18	EROSION CONTROL (1)-(2)
19-24	GRADING PLAN (1)-(6)
25-26	JOINT LAYOUT SHEET (1)-(2)
27-36	PLAN & PROFILE (1)-(10)
37-40	DRAINAGE STRUCTURE PLAN & PROFILE SHEETS (1)-(4)
△ 40A	RIGHT OF WAY FENCING LAYOUT (I-40 MAINLINE)
41-44	IRRIGATION PLANS (1)-(4)
45	SUGGESTED TRAFFIC CONTROL
△ WL1-WL6	OKLAHOMA CITY WATERLINE RELOCATION
T1-T9	TRAFFIC SIGNAL PLANS
T10-T18	TRAFFIC SIGNING & STRIPING PLANS
T19-T22	TRAFFIC LIGHTING PLANS
S1-S14	SURVEY DATA SHEETS (1)-(14)
△ D1-D2	OKLAHOMA CITY ADA CURB RAMP DETAILS (1)-(2)
X1-X22	CROSS SECTIONS (1)-(22)

DESIGN DATA

AADT 2015	=	22,860
AADT (DESIGN)	=	28,710
AADT 2035	=	34,194
K (DHV/ADT)	=	10%
DHV (2 WAY)	=	2,050
D	=	48%
T (% DHV)	=	4%
T (% ADT)	=	6%
T3(% ADT)	=	2%
V	=	25 MPH
20yrFLEX ESALS	=	2.93 M

SCALES

PLAN	1" = 30'
PROFILE HOR.	1" = 30'
VER.	1" = 5'
LAYOUT MAP	1" = 660'

CONVENTIONAL SYMBOLS

	ASPHALT OVERLAY - ROADWAY
	CONCRETE - ROADWAY
	CONCRETE - TRAIL
	PAVEMENT REMOVAL
	PROPOSED ROAD
	RAILROADS
	RANGE & TOWNSHIP
	SECTION LINES
	QUARTER SECTION LINES
	FENCES
	GROUND LINE
	EXISTING ROADS
	BASE LINE
	GRADE LINES
	TELEPHONE & TELEGRAPH
	POWER LINES
	BUILDINGS
	OIL WELL
	DRAINAGE STRUCTURES - IN PLACE
	DRAINAGE STRUCTURES - NEW
	RIGHT-OF-WAY LINES - EXISTING
	RIGHT-OF-WAY LINES - NEW
	CONTROLLED ACCESS
	RIGHT-OF-WAY FENCE

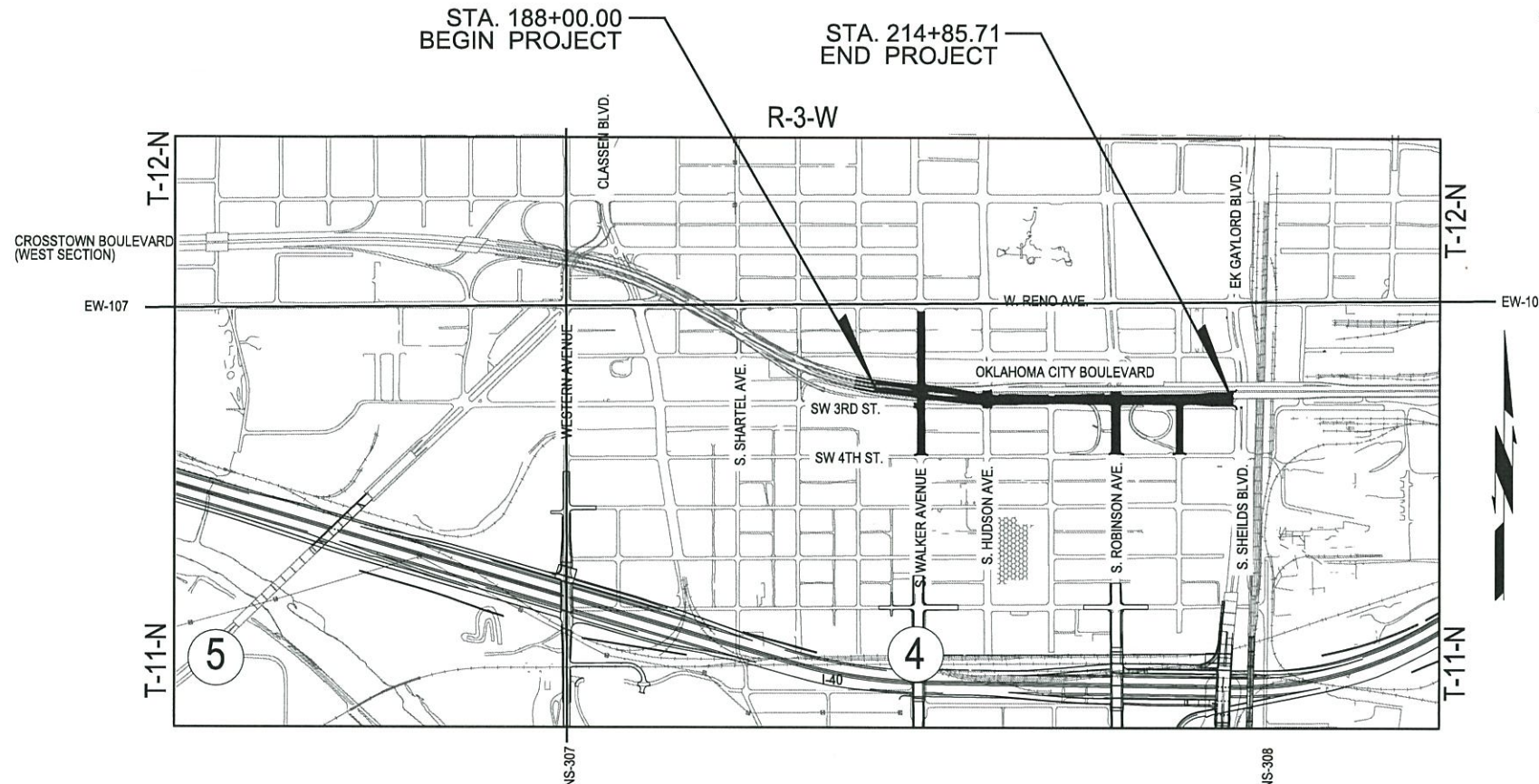
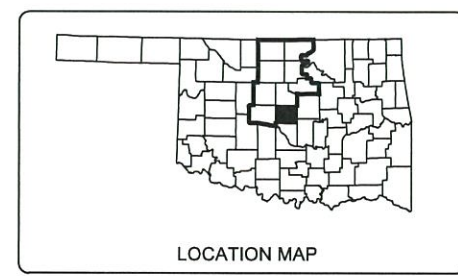

STANDARDS

THE FOLLOWING STANDARDS WILL BE REQUIRED FOR THIS PROJECT:

ROADWAY	TRAFFIC
SSS-1-1	PM1-1-02
LTU-4-0	PM3-1-02
TWD-1-0	PM6-1-00
TSC2-3-2	RSD1-1-00
TSD-2-0	RSD2-1-00
ASCD-5-2	WSD3-1-00
PED-3-2	SBS1-1-00
SSCD-3-1	SBS2-1-00
CI-1-2	GMS1-1-00
SSIF-4-0	SSA2-1-00
CIG-3-0	FGS1-1-00
MFC-4-1	PMAP1-2-00 △
MJB-3-1	SA1-1-02
SPI-4-1	ID1-1-00
SPB-1-4	SNS1-1-02
FHTCP-3-1	TSSS1-1-00
CLB-1-2	PWD1-2-00 △
DC-3-2	CFD1-2-00 △
PDT-1-3	CC1-1-00
TFL-1-1	TSSP1-1-00
LECS-4-1	CCD1-1-00
PBD1-1-00	PBD1-1-00
WCR-3-1	GMF1-2-00 △
OKC STANDARDS	SPD1-1-00
D-700A	SCD1-1-00
D-700B	TEWD1-2-00 △

PROJECT LENGTH BASED ON C.R.L. STATIONING
ROADWAY LENGTH _____ 2685.71 FT. 0.508 MI.
PROJECT LENGTH _____ 2685.71 FT. 0.508 MI.

MacArthur Associated Consultants
3032 N.W. 63rd Street, Suite 2004 - Oklahoma City, OK 73162 • 405.848.2471
C.R.A. No. 888 Renewal Date: 06-30-17

KEITH B. ANGIER 5/12/17
KEITH B. ANGIER, P.E. OKLA. REG. NO. 17097 DATE

OKLAHOMA DEPARTMENT OF TRANSPORTATION	DEPARTMENT OF TRANSPORTATION FEDERAL HIGHWAY ADMINISTRATION
DATE APPROVED _____	DATE APPROVED _____
BY _____	BY _____
CHIEF ENGINEER	DIVISION ADMINISTRATOR
SWO 3367(1)	PROJECT NO. 17428(89) SHEET NO. 1

PRINT DATE: 5/12/2017 T:\1024-06\Drawings\Roadway\1024-06-T11a.dgn

2009 OKLAHOMA STANDARD SPECIFICATIONS FOR HIGHWAY CONSTRUCTION - ENGLISH GOVERN, APPROVED BY THE U.S. DEPARTMENT OF TRANSPORTATION, FEDERAL HIGHWAY ADMINISTRATION, JANUARY 04, 2010.